

### KEY BENEFITS SUMMARY

- Certified to the latest British and European standards EN 1366-3 and EN 13501: Pt 2
- Provides an effective barrier to the spread of smoke and fire for up to 2 hours
- Ready to use, and easy to install. No mechanical fixing required
- Can be utilised internally within Nullifire B747-50 Coated Board System

### PRODUCT INFORMATION

#### Description

Nullifire B300 is a simple to use self adhesive intumescent pipe wrap used for sealing plastic and composite pipe penetrations.

#### Usage / Purpose

Nullifire B300 is used to stop the spread of smoke and fire along services that pass through compartment walls and floors. The wrap fits around the circumference of the pipe within the depth of the substrate. In the event of a fire B300 prevents the passage of fire and smoke by closing off the aperture within the compartment floor or wall when penetrated by plastic pipes. B300 is suitable for use with all common plastic and composite pipes (PVC, ABS, PE, PP, PB). Typical areas of use include health and leisure facilities, schools, universities, commercial, retail and industrial buildings.

### Available Sizes

Sizes 55 mm – 160 mm

Pipe Size (mm)	Wrap Width (mm)	Wrap Length (mm)	Wrap Thickness (mm)
55	60	183	3.5
82	60	274	3.5
110	60	368	6
160	60	559	9.5

### Packaging

Supplied 20 per box

### Availability

Direct from Nullifire (see back of leaflet for address and telephone details).

### USAGE GUIDELINES

#### Necessary Tools

Suitable material to seal any remaining gaps such as M701 Acrylic, B220 Structural Compound or B270 High Strength Structural Compound.

#### Preparation

- Ensure aperture is of sufficient size to accommodate Pipe Wrap with approximately 10 mm gap.

#### Installation

- Place Nullifire B300 Pipe Wrap around pipe and secure using adhesive tab.
- Push Wrap into position. Allow approximately 10 mm between the surface of the aperture and the edge of the Wrap
- Fill gap around the pipe and Wrap with Nullifire B220 Compound

#### Maintenance

No maintenance required after installation. Routine inspection recommended to ensure no damage.

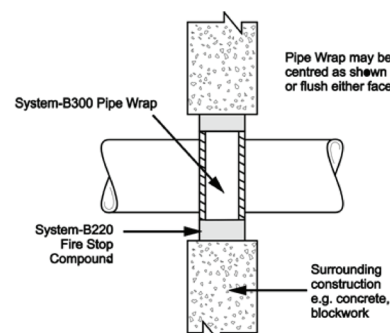

**WALL SEALS** (for wall thicknesses up to 150mm)

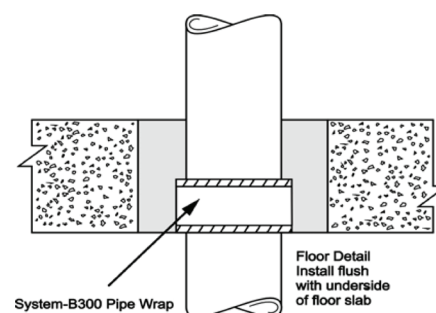

**FLOOR SEALS**

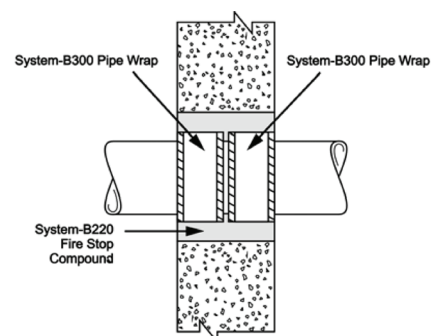

**WALL SEALS** (for wall thicknesses over 150mm)

# B300

Nullifire - a brand of Tremco illbruck Ltd  
 Torrington Avenue  
 Coventry, West Midlands CV4 9TJ  
 Tel: 02476 855000  
 Fax: 02476 469547  
 Email: protect@nullifire.com  
 Website: www.nullifire.co.uk

## PERFORMANCE

FIRE PERFORMANCE: Tested in accordance with BS 476: Part 20:1987 and EN 1366-3:2004

Substrate	Pipe Material	Pipe Diameter	Integrity	Insulation
Masonry Wall (single wrap central position)	PVC	Up to 160	120	120
	PP	Up to 55 55 - 160	60 120	30 120
	PE	Up to 55	120	120
	Composite Aluplex	Up to 55 55 - 160	120 60	120 60
	ABS	Up to 160	120	120
Masonry Floor (single wrap)	PVC	Up to 160	120	120
	PP	Up to 160	120	120
	PE	Up to 56	120	120
	Composite ABS/ASA/PVC	Up to 52 52 - 160	120 60	120 60
	PVC Duct	110 x 54 310 x 28 180 x 95	120	120
Masonry Wall (two wraps either side and flush with substrate)	PVC	Up to 160	120	120
	PP	Up to 110 110 - 160	120 120	120 60
	PE	Up to 110 110 - 160	120 120	120 60
	Composite Aluplex	40 75	120 120	120 60
	ABS	Up to 160	120	120

### Storage

Store between +5°C and +35°C in dry conditions.

### Shelf Life

Unlimited when stored as recommended.

### Health & Safety Precautions

Product Safety Data Sheet must be read and understood before use.

### Technical Service

Nullifire has a team of experienced Technical Sales Representatives who provide assistance in the selection and specification of products. For

more detailed information, service and advice, please call Customer Services on 02476 855000.

### Guarantee / Warranty

This information is offered in good faith but without guarantee or liability. In cases of doubt, users should consult with relevant authority.

Information given herein is supplied for your guidance only and is based upon the results of controlled tests and experience obtained in the application of the product referred to by Nullifire. As the supplier only, Nullifire has no

control over the method or conditions of application of the product and consequently no warranties expressed or implied are intended to be given as to the coverage or performance of the products mentioned or referred to herein and no liability will be excepted for any loss, damage or physical injury resulting from the use or application of the information, data or products mentioned or referred to herein.